



1. REMOVE ALL BULK MAINS, RISERS, PIPES, SPRINKLER HEADS, AND PIPE HANGERS.
2. CUT AND CAP 6" SPRINKLER MAIN AT A CONVENIENT HEIGHT ABOVE CELL FLOOR.
3. CUT AND CAP 8" SPRINKLER MAIN IN RISER ROOM BELOW FLOOR LEVEL. PATCH FLOOR WITH GROUT TO FLUSH. REMOVE RISER ROOM AND ASSOCIATED EQUIPMENT.
4. RUN NEW VICTAULC LINE FROM 396/14 NEAR COLUMN M15, ALONG M-LINE TO M22. RUN 6" DOWN TO NEW RISER ON GROUND FLOOR AND TIE INTO SYSTEM 392/12 6" LINE TO CELL FLOOR. SPECIFIC LOCATION OF NEW 6" LINE MAY BE ADJUSTED DUE TO FIELD CONDITIONS.
5. REFER TO TFR-SE-2016-0298 AND TFR-SE-2016-0275 FOR ANY ADDITIONAL MATERIAL TO BE ORDERED.
6. SEE DRAWING X-330 SP 4-4613 AND X-330 SP 4-4614.
7. SPRINKLER SYSTEMS SHALL NOT BE REMOVED UNTIL APPROVED BY THE DEPARTMENT OF ENERGY.

NOTE:
FOR DETAILS OF PIPE HANGERS &
GENERAL NOTES SEE SHEET 4.4610.
HANGERS FOR CROSS MAINS ARE
SHOWN ON SPRINKLER PLANS.

This document has been reviewed and is UNCLASSIFIED and NOT UCNI. This review does not constitute clearance for public release.

#192	*DIG. SIG.
Authorized Derivative Classifier	Date

* DESIGN MANAGER:
APPROVAL AND DATE:

POOR QUALITY ORIGINAL
BASE DOCUMENT: X-330 SP 4-4612 REVISION 0 CAD OVERLAY

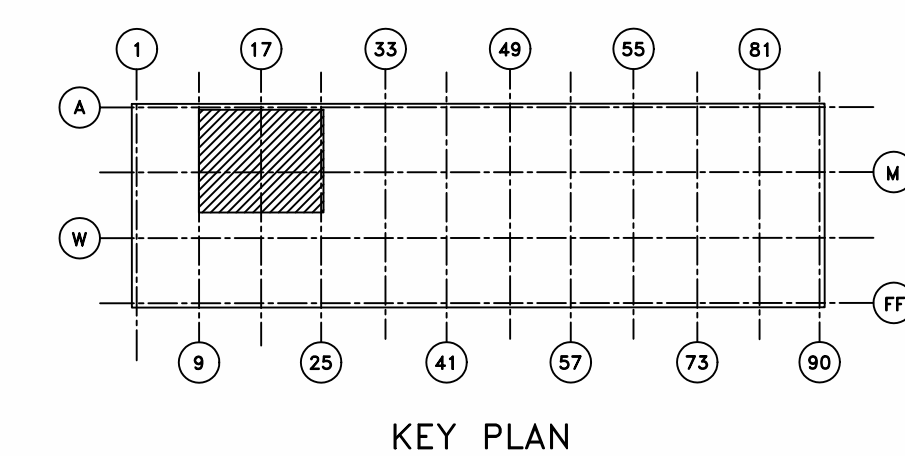

KEY PLAN

DRAWING APPROVED—DATE		DRAWING APPROVED—DATE		DRAWING APPROVED—DATE	
J. F. WILKINSON 5-22-58		J. D. WILKINSON 5-22-58		L. H. JACKSON 5-24-58	
ARCHITECT ENGINEER		OPERATING CONTRACTOR		A. E. C. ENGINEER	
DRAWN BY G. CORNWELL		SCALE 1"=10'		DATE 5/20/58	
DESIGN E. E. C.		APPROVED [Signature]		CHECK NO. 20	
PROJECT PORTSMOUTH		BUILDING X-330 SP 4-4612		SHEET REV	
SHEET NO. X-330 SP 4-4614		REFERENCE DRAWINGS		A01	